

Socket Allen Screw

Head Style: Cap Head

Drive Type: Internal Hex

Thread Type: Metric - Coarse

Material: Stainless Steel

Class Grade: A4-70 G316

Corrosion Protection Level: Ultimate

Standard: DIN 912 / ISO 4762

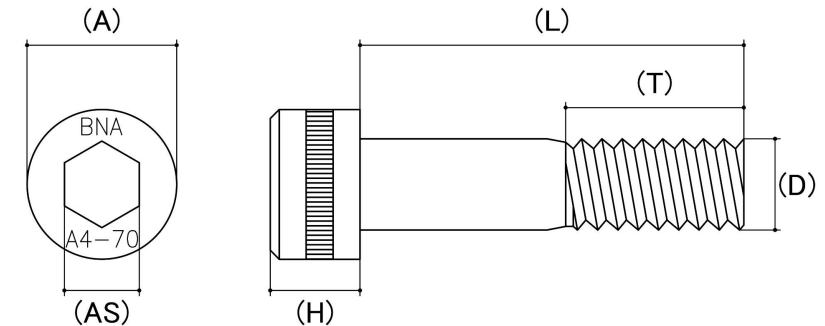

*Cad Drawings shown for graphic representation only.**

Size	Thread Pitch (mm)	Thread Type	Product Diameter (D) (mm)		Head Diameter (A) (mm)		Head Height (H) (mm)		Driver Bit Size (AS) (mm)	sku (Part Number)
			Min	Max	Min	Max	Min	Max		
M1.6	0.35mm	Coarse	1.49	1.58	2.86	3.00	1.46	1.70	1	31S1.6M
M2	0.40mm	Coarse	1.88	1.98	3.62	3.80	1.86	2.00	1	31S2M
M2.5	0.45mm	Coarse	2.38	2.48	4.32	4.50	2.36	2.50	2	31S25M
M3	0.50mm	Coarse	2.87	2.98	5.32	5.50	2.86	3.00	2	31S3M
M4	0.70mm	Coarse	3.83	3.97	6.78	7.00	3.82	4.00	3	31S4MFT
M5	0.80mm	Coarse	4.82	5.00	8.28	8.50	4.82	5.00	4	31S5MFT
M6	1.00mm	Coarse	5.82	6.00	9.78	10.00	5.70	6.00	5	31S6M
M8	1.25mm	Coarse	7.78	8.00	12.73	13.00	7.64	8.00	6	31S8M
M10	1.50mm	Coarse	9.78	10.00	15.73	16.00	9.64	10.00	8	31S10M
M12	1.75mm	Coarse	11.73	12.00	17.73	18.00	11.57	12.00	10	31S12M
M14	2.00mm	Coarse	13.73	14.00	20.67	21.00	13.57	14.00	12	31S14M
M16	2.00mm	Coarse	15.73	16.00	23.73	24.00	15.57	16.00	14	31S16M
M20	2.50mm	Coarse	19.67	20.00	29.53	30.00	19.73	20.00	17	31S20M

Disclaimer:

Dimensional data and technical information was obtained from publically available sources and not acquired through standard agencies. It has been completed and compiled for reference purposes only; where discrepancies are found they are subject to change without notice. Bolt & Nut Australia makes no warranties or representations regarding the accuracy and validity of the compiled information and data. Contact the relevant standard authorities for accurate and detailed information.

* Cad Drawings may not reflect diameter, thread length or overall length.

© Bolt & Nut Australia Pty Ltd. All rights reserved.

Version: 29 Aug 2024